

Modular Open Plan Kitchens

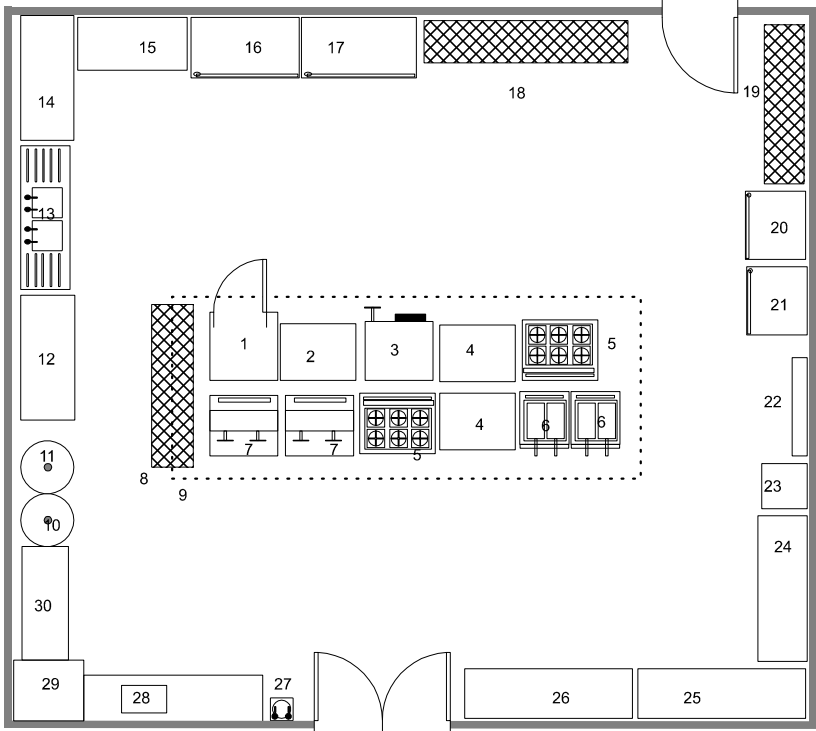

- Open Plan Kitchen
1. Combi oven
 2. Stainless Steel Table
 3. Braitt pan
 4. 2x Stainless Steel Tables
 5. 2 x Six burner oven
 6. 2 x double fryers
 7. 2 x grills
 8. Chromate racking for pans
 9. Extraction system
 10. Water boiler
 11. Water boiler
 12. Stainless Steel Table
 13. Preparation sink
 14. Table
 15. Table
 16. Double door fridge
 17. Double door fridge
 18. Chromate racking
 19. Chromate racking
 20. Single door freezer
 21. Single door freezer
 22. Electrical board
 23. Stainless Steel Table
 24. Stainless Steel Table
 25. Stainless Steel Table
 26. Stainless Steel Table
 27. Wash hand basin
 28. Dishwash in table
 29. Dishwasher
 30. Dishwash out table

Note: All dimensions in millimetres.
Do not scale, please check all dimensions on site.

COPYRIGHT: No copies of this drawing are to be distributed or veiwed without permission from Onsite Kitchens LTD



Holly Road, Red Marsh Industrial Estate,
Thornton Cleveleys, Lancashire FY5 4HH
Telephone: 01253 863305
Facsimile: 01253 857139

Email : sales@onsitekitcens.com

Client
Modular
Kitchens

Dwg Title

Date	Scale
Drawing no	Revision